

Drag Conveyor Flight Styles Identification Chart

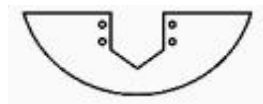

Essmuller

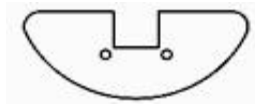

Jeffery

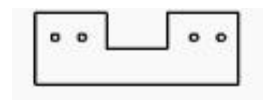

En Masse



Screw Conveyor



Thomas Conveyor



Ersham

Drag Conveyor Flights (UHMW)

| FLIGHT SIZE (Nominal) Inches | SCREW CONVEYOR | ESSMUELLER COMPANY | THOMAS CONVEYOR | JEFFERY | ERSHAM | EN MASSE | FLIGHT WEIGHT (Average) Pounds |
|---------------------------------------|-------------------|-----------------------|--------------------|-------------------|---------------|----------|---|
| | <i>Superflo</i> | <i>Peerless</i> | <i>Fli-Con</i> | <i>Multi-Flow</i> | <i>Dracon</i> | | |
| 6 x 1/4 | X | | | X | | X | 0.06 |
| 6 x 3/8 | X | | X | | X | X | 0.10 |
| 9 x 1/4 | X | | | X | | X | 0.17 |
| 9 x 3/8 | X | X | | X | X | X | 0.22 |
| 9 x 1/2 | X | X | X | | | X | 0.29 |
| 10 x 3/8 | | | | X | | X | 0.29 |
| 10 x 1/2 | | | | X | | X | 0.36 |
| 12 x 3/8 | X | X | | X | X | X | 0.38 |
| 12 x 1/2 | X | X | X | | | X | 0.46 |
| 14 x 3/8 | X | X | | X | X | X | 0.54 |
| 14 x 1/2 | X | X | | | | X | 0.68 |
| 16 x 3/8 | X | X | | X | | X | 0.82 |
| 16 x 1/2 | X | X | X | | | X | 1.04 |
| 18 x 3/8 | X | | | X | | X | 1.27 |
| 18 x 1/2 | X | X | | | | X | 1.60 |
| 20 x 1/2 | | X | | X | | X | 2.47 |
| 20 x 5/8 | | | X | | | X | 3.12 |
| 24 x 1/2 | | X | | X | | X | 5.83 |
| 24 x 5/8 | | | X | | | X | 7.38 |

**All sizes are nominal length x thickness

Need a distributor in your area? Please contact T.O.P.S. Inc. at 877-326-4704!!



2641 Metro Blvd. Maryland Heights, MO 63043
(Phone) 636-326-4700 (Fax) 314-395-8671 (Online) www.topsinc.us